



GRIDLOCK[®]
SECURITY PRODUCTS

Contract range of locks and latches



EN 12209-2003

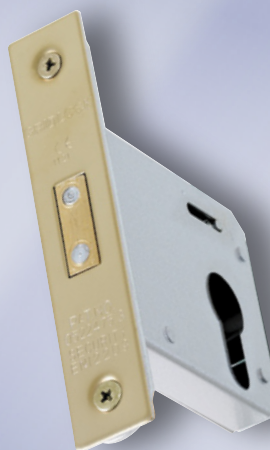

INTELLIGENT BY DESIGN

Tested

The Gridlock Security Products contract range of locks and latches has all been successfully tested at Warrington Certification Ltd to meet the requirements of the current European standard EN12209-2003 for locks and latches. Warrington certification Ltd has also approved the range for CE marking. The CE marking of the product proves that the item has been tested to the appropriate standard and has met all the quality control requirements.

Features

The Gridlock Security Products range of locks and latches features the patented ROTALATCH latchbolt reverse system. This enables the latchbolt to be handed easily without the need for any additional tools. This can also be done without removing the lock or latch from the door if already fitted. The range is available in three finishes comprising of satin stainless steel, polished stainless steel and Evershine[PVD] brass finish. There are also radius forends and strike plates available in all finishes. All the range is supplied complete with a nylon box keep to improve the aesthetics of the fitted product.

Development

Intelligent Hardware is continuing to develop our ranges, shortly there will be available a range of Architectural and DIN standard locks and latches which will have undergone testing to EN12209 and will be CE approved.

Contents

	Page No.
Rotalatch bolt reverse mechanism	1
51.01 Tubular mortice latch	2
51.03 Upright mortice latch	3
51.05 3 Lever mortice sashlock	4
51.07 Mortice bathroom lock	5
51.08 Mortice euro cylinder sashlock case	6
51.09 Mortice locking latch	7
51.11 3 Lever mortice deadlock	8
51.12 Mortice euro cylinder deadlock case	9
51.13 Mortice oval cylinder sashlock case	10
51.14 Mortice oval cylinder deadlock case	11
Strike Plates and Forends	12
EN12209 - 2003 Classification	13

The new lock range featuring patented bolt reverse mechanism

1. Remove outer forend

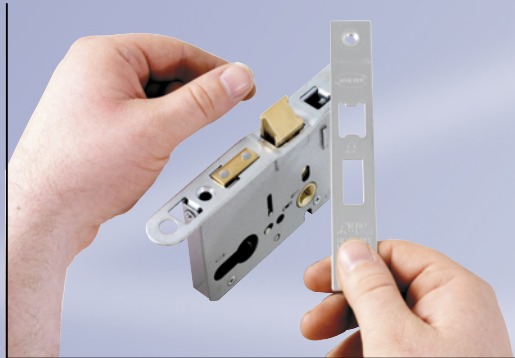

2. Rotate latchbolt 180°



3. Latchbolt reversed



4. Replace forend



INTELLIGENT BY DESIGN

51.01 Tubular Mortice Latch

EN12209-2003

1 C 5 1 0 F - B 0 N 0

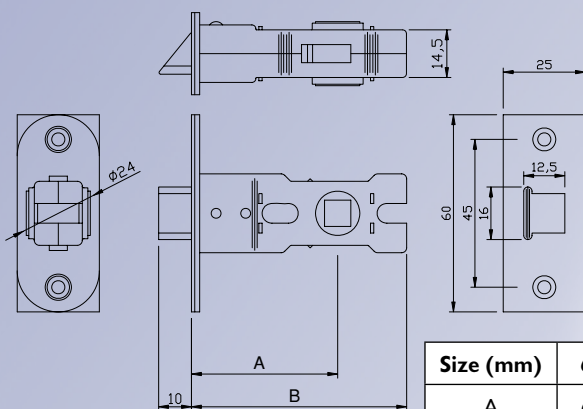

Size (mm)	65	75	90
A	65	75	90
B	45	55	65

Spare Parts Available:

CODE	DESCRIPTION	SIZE	FINISH
52.10	Rebate Set	13mm	Evershine Brass, PSS & SSS
52.17	Nylon Box Keeps	x	Black
52.14	Square Strike Plate	x	Evershine Brass, PSS & SSS
52.13	Rounded Strike plate	x	Evershine Brass, PSS & SSS
52.20	Square Forend	x	Evershine Brass, PSS & SSS
52.21	Rounded Forend	x	Evershine Brass, PSS & SSS

- 65mm, 75mm and 90mm case sizes available.
- Forends & strikers finished in Evershine Brass (ES), guaranteed not to discolour for 10 years, Satin or Polished Stainless Steel.
- Forends supplied with protective removable film.
- Guided latch bolt, from solid brass.
- Lightly sprung, suitable for sprung lever furniture.
- Fits comfortably into 25mm diameter hole.
- Suitable for bolt-thru door furniture, from 30mm to 40mm centres.
- Latch bolt will withdraw fully with only 25-30degree depression of the lever handle.
- Strike plate can be adjusted to avoid door leaf rattle.
- Suitable for use on fire doors. Tested in a fire door to EN1634-1.
- Replaceable forends and strikers available rounded and square.
- Black nylon box keep available to fit behind striker.
- Individually poly-bagged, each with 4no 20mm long matching fixing screws.



51.03 Upright Latch

EN12209-2003

1 C 7 1 0 C - B 0 1 0



- 65mm, 75mm and 100mm case sizes available.
- Forends & strikers finished in Evershine Brass, guaranteed finish for 10 years, Satin and Polished Stainless Steel.
- Forends supplied with protective removable film.
- Guided latch bolt, from solid brass.
- Incorporates patented **ROTALATCH® BOLT REVERSE MECHANISM**.
- Lightly sprung, suitable for sprung lever furniture.
- Light duty, suitable for domestic situations, housing or apartments.
- Suitable for horizontal bolt-thru door furniture, from 30mm to 40mm centres.
- Incorporates 6 o'clock vertical bolt-thru position at 21.5mm centres.
- Latch bolt will withdraw fully with only 25-30degree depression of the lever handle.
- Strike plate can be adjusted to avoid door leaf rattle.
- Suitable for use on fire doors. Tested in a fire door to EN1634-1.
- Replaceable forends and strikers available rounded and square.

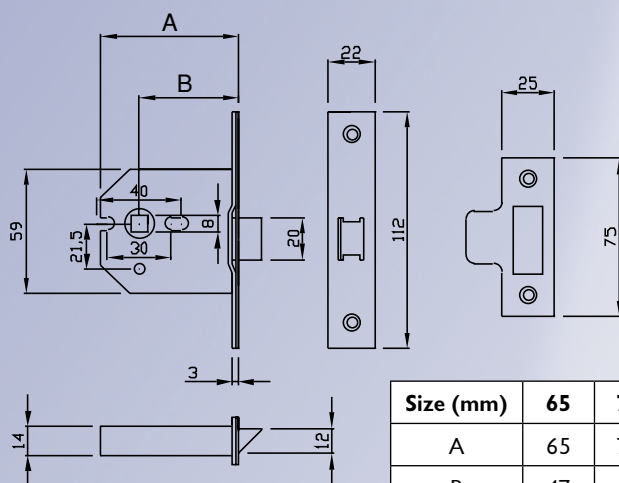

Size (mm)	65	75	100
A	65	75	100
B	47	57	67

Spare Parts Available:

CODE	DESCRIPTION	SIZE	FINISH
52.05	Rebate Set	13mm	Evershine Brass, PSS & SSS
52.17	Nylon Box Keeps	x	Black
52.14	Square Strike Plate	x	Evershine Brass, PSS & SSS
52.13	Rounded Strike plate	x	Evershine Brass, PSS & SSS
52.28	Square Forend	x	Evershine Brass, PSS & SSS
52.29	Rounded Forend	x	Evershine Brass, PSS & SSS



51.05

3 Lever Mortice Sash Lock

EN12209-2003

1 C 7 1 0 C 1 K D 1 A

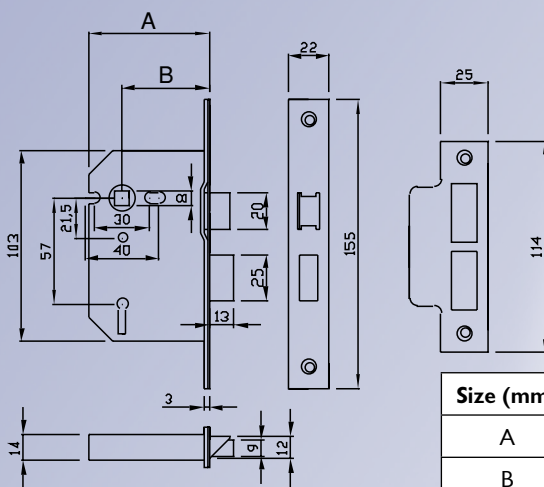

Size (mm)	65	75
A	65	75
B	47	57

Spare Parts Available:

CODE	DESCRIPTION	SIZE	FINISH
52.09	Rebate Set	13mm	Evershine Brass, PSS & SSS
52.07	Rounded Strike plate	x	Evershine Brass, PSS & SSS
52.08	Nylon Box Keeps	x	Black
52.24	Square Forend	x	Evershine Brass, PSS & SSS
52.11	Square Strike Plate	x	Evershine Brass, PSS & SSS
52.25	Rounded Forend	x	Evershine Brass, PSS & SSS
52.16A	Key blanks A	x	
52.16B	Key blanks B	x	



- 65mm and 75mm case sizes available.
- Forends & strikers finished in Evershine PVD Brass, guaranteed finish for 10 years, Satin and Polished Stainless Steel.
- Forends supplied with protective removable film.
- Guided latch bolt, from solid brass.
- Incorporates patented **ROTALATCH** BOLT REVERSE MECHANISM.
- Lightly sprung, suitable for sprung lever furniture.
- Suitable for horizontal bolt-thru door furniture, from 30mm to 40mm centres.
- Incorporates 6 o'clock vertical bolt-thru position at 21.5mm centres.
- Latch bolt will withdraw fully with only 25-30degree depression of the lever handle.
- Strike plate can be adjusted to avoid door leaf rattle.
- Suitable for use on fire doors. Tested in a fire door to EN1634-1.
- Complete with 2 keys.
- 100 number of key differs (2 key sections).



51.07 Mortice Bathroom Lock

EN12209-2003

1 C 7 1 0 C - B A 1 0



- 65mm and 75mm case sizes available.
- Forends & strikers finished in Evershine PVD Brass, guaranteed finish for 10 years, Satin and Polished Stainless Steel.
- Forends supplied with protective removable film.
- Guided latch bolt, from solid brass.
- Incorporates patented  BOLT REVERSE MECHANISM.
- Lightly sprung, suitable for sprung lever furniture.
- Suitable for horizontal bolt-thru door furniture, from 30mm to 40mm centres.
- Incorporates 6 o'clock vertical bolt-thru position at 21.5mm centres.
- Latch bolt will withdraw fully with only 25-30 degree depression of the lever handle.
- Strike plate can be adjusted to avoid door leaf rattle.
- Suitable for use on fire doors. Tested in a fire door to EN1634-1.
- Replaceable forends and strikers available rounded and square.
- Complete with nylon box keep to fit behind striker.

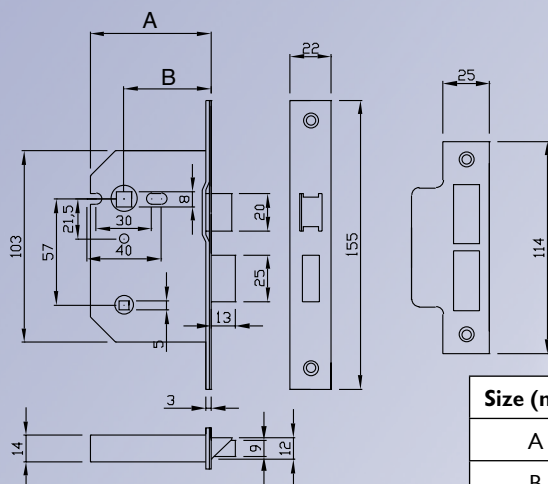

Size (mm)	65	75
A	65	75
B	47	57

Spare Parts Available:

CODE	DESCRIPTION	SIZE	FINISH
52.09	Rebate Set	13mm	Evershine Brass, PSS & SSS
52.07	Rounded Strike plate	x	Evershine Brass, PSS & SSS
52.08	Nylon Box Keeps	x	Black
52.24	Square Forend	x	Evershine Brass, PSS & SSS
52.11	Square Strike Plate	x	Evershine Brass, PSS & SSS
52.25	Rounded Forend	x	Evershine Brass, PSS & SSS

51.08

Euro Profile Sashlock Case

EN12209-2003

1 C 7 1 0 C 1 B A 1 0

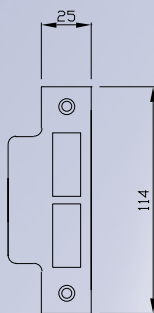
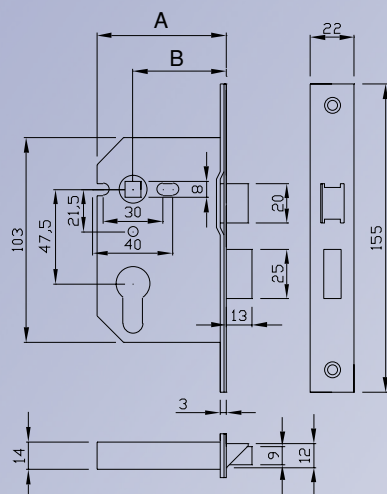

Size (mm)	65	75
A	65	75
B	47	57

Spare Parts Available:

CODE	DESCRIPTION	SIZE	FINISH
52.09	Rebate Set	13mm	Evershine Brass, PSS & SSS
52.07	Rounded Strike plate	x	Evershine Brass, PSS & SSS
52.08	Nylon Box Keeps	x	Black
52.24	Square Forend	x	Evershine Brass, PSS & SSS
52.11	Square Strike Plate	x	Evershine Brass, PSS & SSS
52.25	Rounded Forend	x	Evershine Brass, PSS & SSS



- 65mm and 75mm case sizes available.
- Forends & strikers finished in Evershine Brass, guaranteed finish for 10 years, Satin and Polished Stainless Steel.
- Forends supplied with protective removable film.
- Guided latch bolt, from solid brass.
- Incorporates patented **ROTALATCH** BOLT REVERSE MECHANISM.
- Lightly sprung, suitable for sprung lever furniture.
- Suitable for horizontal bolt-thru door furniture, from 30mm to 40mm centres.
- Incorporates 6 o'clock vertical bolt-thru position at 21.5mm centres.
- Deadbolt incorporates hardened steel anti-saw rollers for extra security.
- Latch bolt will withdraw fully with only 25-30degree depression of the lever handle.
- Strike plate can be adjusted to avoid door leaf rattle.
- Suitable for use on fire doors. Tested in a fire door to EN1634-1.
- Replaceable forends and strikers available rounded and square.



51.09 Mortice Locking Latch

EN12209-2003

1 C 7 1 0 C - B A 1 0



- 70mm case size
- Forends & strikers finished in Evershine PVD Brass, guaranteed finish for 10 years, Satin and Polished Stainless Steel.
- Forends supplied with protective removable film.
- Guided latch bolt, from solid brass.
- Incorporates patented  BOLT REVERSE MECHANISM.
- Lightly sprung, suitable for sprung lever furniture.
- Light duty, suitable for domestic situations, housing or apartments.
- Suitable for horizontal bolt-thru door furniture, from 30mm to 40mm centres.
- Incorporates 6 o'clock vertical bolt-thru position at 21.5mm centres.
- Latch bolt will withdraw fully with only 25-30degree depression of the lever handle.
- Strike plate can be adjusted to avoid door leaf rattle.
- Suitable for use on fire doors. Tested in a fire door to EN1634-1.
- Replaceable forends and strikers available rounded and square.
- Black nylon box keep available to fit behind striker.
- Individually poly-bagged, each with 4no 20mm long matching fixing screws.

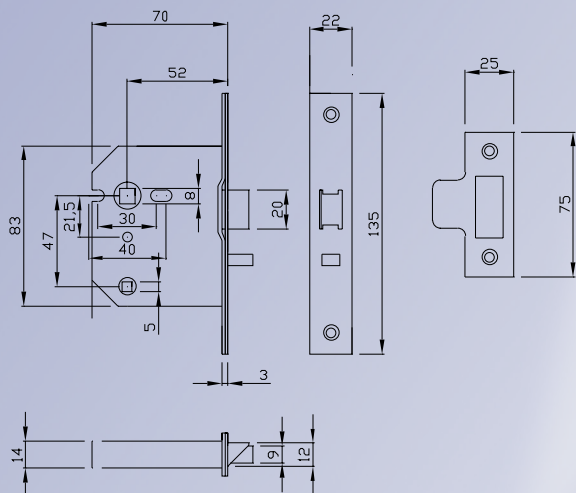

Spare Parts Available:

CODE	DESCRIPTION	SIZE	FINISH
52.12	Rebate Set	13mm	Evershine Brass, PSS & SSS
52.17	Nylon Box Keeps	x	Black
52.14	Square Strike Plate	x	Evershine Brass, PSS & SSS
52.13	Rounded Strike plate	x	Evershine Brass, PSS & SSS
52.26	Square Forend	x	Evershine Brass, PSS & SSS
52.27	Rounded Forend	x	Evershine Brass, PSS & SSS

51.11

3 Lever Mortice Deadlock

EN12209-2003

1 C 7 1 0 C 1 K D 0 A



- 65mm and 75mm case sizes available.
- Forends & strikers finished in Evershine PVD Brass, guaranteed finish for 10 years, Satin and Polished Stainless Steel.
- Forends supplied with protective removable film.
- Light duty, suitable for domestic situations, housing or apartments.
- Suitable for use on fire doors. Tested in a fire door to EN1634-1.
- Replaceable forends and strikers available rounded and square.
- Black nylon box keep available to fit behind striker.
- Individually poly-bagged, each with 4no 20mm long matching fixing screws
- Complete with 2 keys.
- 100 number of key differs (2 key sections).

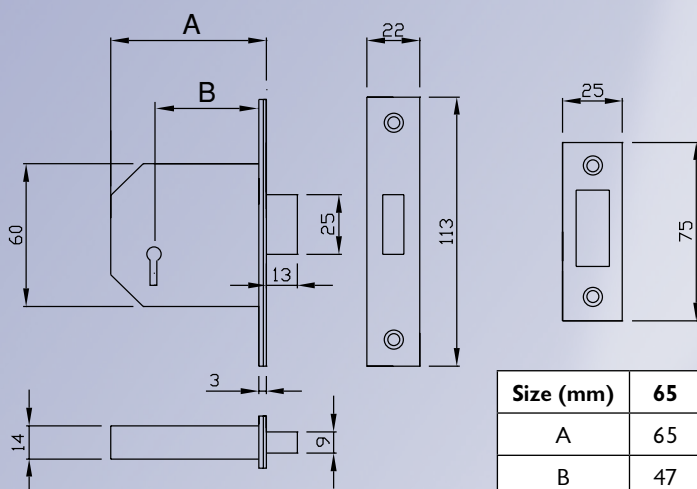

Size (mm)	65	75
A	65	75
B	47	57

Spare Parts Available:

CODE	DESCRIPTION	SIZE	FINISH
52.23	Rebate Set	13mm	Evershine Brass, PSS & SSS
52.18	Rounded Strike plate	x	Evershine Brass, PSS & SSS
52.17	Nylon Box Keeps	x	Black
52.32	Square Forend	x	Evershine Brass, PSS & SSS
52.19	Square Strike Plate	x	Evershine Brass, PSS & SSS
52.33	Rounded Forend	x	Evershine Brass, PSS & SSS
52.16A	Key blanks A	x	
52.16B	Key blanks B	x	



51.12 Euro Profile Deadlock Case

EN12209-2003

1 C 7 1 0 C 1 B A 0 0



- 65mm and 75mm case sizes available.
- Forends & strikers finished in Evershine PVD Brass, guaranteed finish for 10 years, Satin and Polished Stainless Steel.
- Forends supplied with protective removable film.
- Light duty, suitable for domestic situations, housing or apartments.
- Deadbolt incorporates hardened steel anti-saw rollers for extra security.
- Suitable for use on fire doors. Tested in a fire door to EN1634-1.
- Replaceable forends and strikers available rounded and square.
- Black nylon box keep available to fit behind striker.
- Individually poly-bagged, each with 4no 20mm long matching fixing screws

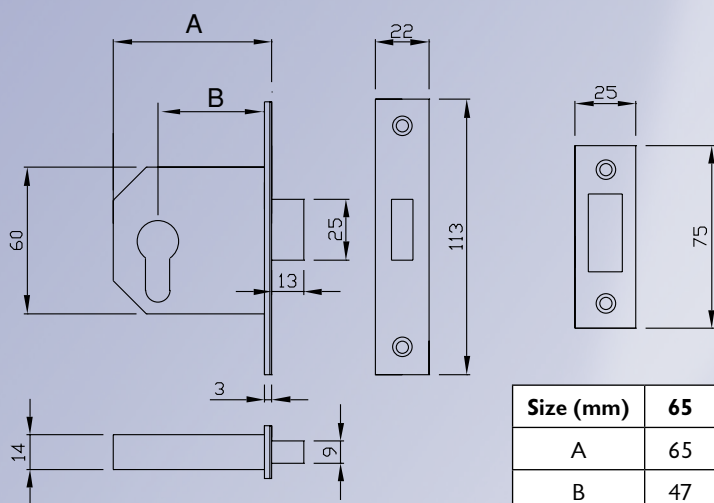

Size (mm)	65	75
A	65	75
B	47	57

Spare Parts Available:

CODE	DESCRIPTION	SIZE	FINISH
52.23	Rebate Set	13mm	Evershine Brass, PSS & SSS
52.18	Rounded Strike plate	x	Evershine Brass, PSS & SSS
52.17	Nylon Box Keeps	x	Black
52.32	Square Forend	x	Evershine Brass, PSS & SSS
52.19	Square Strike Plate	x	Evershine Brass, PSS & SSS
52.33	Rounded Forend	x	Evershine Brass, PSS & SSS



51.13 Oval Profile Sashlock Case

EN12209-2003

1 C 7 1 0 C 1 B A 1 0

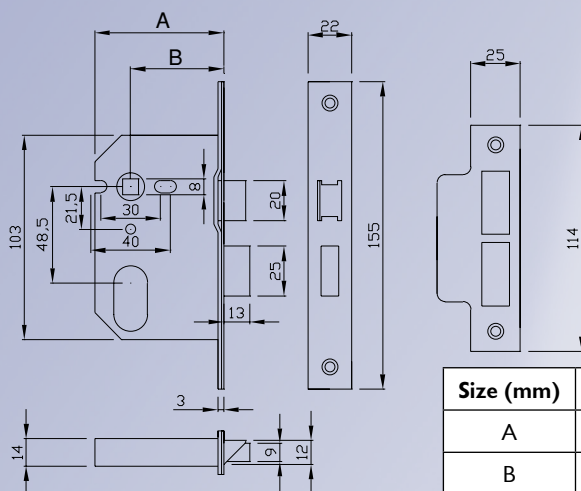

Size (mm)	65	75
A	65	75
B	47	57

Spare Parts Available:

CODE	DESCRIPTION	SIZE	FINISH
52.09	Rebate Set	13mm	Evershine Brass, PSS & SSS
52.07	Rounded Strike plate	x	Evershine Brass, PSS & SSS
52.08	Nylon Box Keeps	x	Black
52.24	Square Forend	x	Evershine Brass, PSS & SSS
52.11	Square Strike Plate	x	Evershine Brass, PSS & SSS
52.25	Rounded Forend	x	Evershine Brass, PSS & SSS



- 65mm and 75mm case sizes available.
- Forends & strikers finished in Evershine Brass (ES), guaranteed finish for 10 years, Satin and Polished Stainless Steel.
- Forends supplied with protective removable film.
- Guided latch bolt, from solid brass.
- Incorporates patented **ROTALATCH® BOLT REVERSE MECHANISM**.
- Lightly sprung, suitable for sprung lever furniture.
- Suitable for horizontal bolt-thru door furniture, from 30mm to 40mm centres.
- Incorporates 6 o'clock vertical bolt-thru position at 21.5mm centres.
- Deadbolt incorporates hardened steel anti-saw rollers for extra security.
- Latch bolt will withdraw fully with only 25-30degree depression of the lever handle.
- Strike plate can be adjusted to avoid door leaf rattle.
- Suitable for use on fire doors. Tested in a fire door to EN1634-1.
- Replaceable forends and strikers available rounded and square.



51.14

Oval Profile Deadlock Case

EN12209-2003

1 C 7 1 0 C 1 B A 0 0



- 65mm and 75mm case sizes available.
- Forends & strikers finished in Evershine PVD Brass, guaranteed finish for 10 years, Satin and Polished Stainless Steel.
- Forends supplied with protective removable film.
- Light duty, suitable for domestic situations, housing or apartments.
- Deadbolt incorporates hardened steel anti-saw rollers for extra security.
- Suitable for use on fire doors. Tested in a fire door to EN1634-1.
- Replaceable forends and strikers available rounded and square.
- Black nylon box keep available to fit behind striker.
- Individually poly-bagged, each with 4no 20mm long matching fixing screws

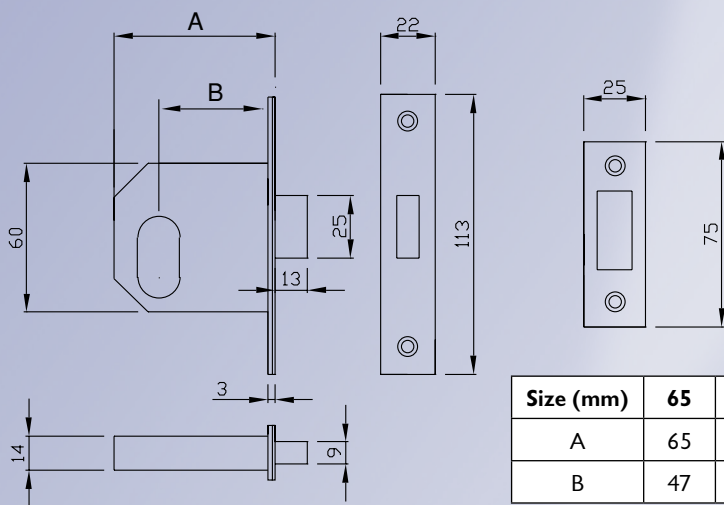

Size (mm)	65	75
A	65	75
B	47	57

Spare Parts Available:

CODE	DESCRIPTION	SIZE	FINISH
52.23	Rebate Set	13mm	Evershine Brass, PSS & SSS
52.18	Rounded Strike plate	x	Evershine Brass, PSS & SSS
52.17	Nylon Box Keeps	x	Black
52.32	Square Forend	x	Evershine Brass, PSS & SSS
52.19	Square Strike Plate	x	Evershine Brass, PSS & SSS
52.33	Rounded Forend	x	Evershine Brass, PSS & SSS



STRIKE PLATES

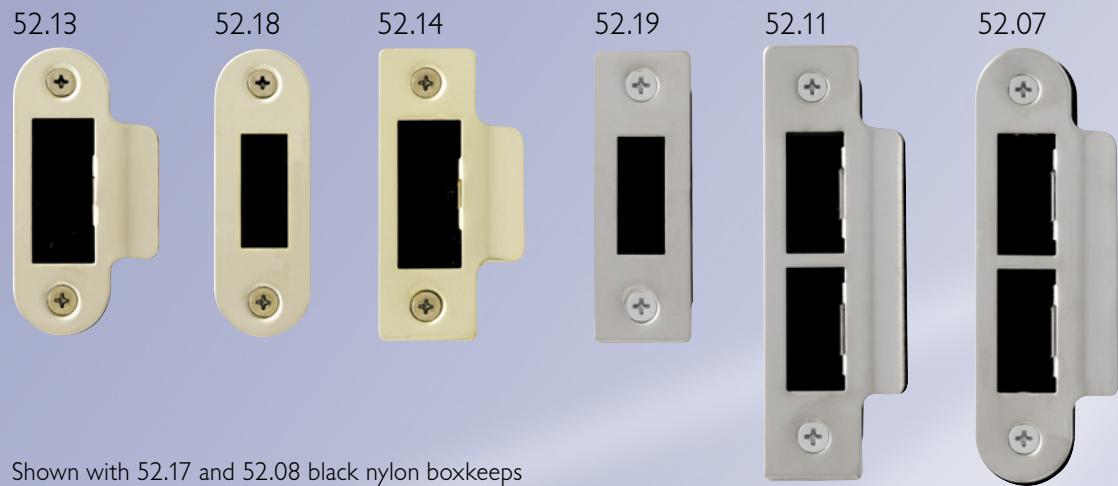

FORENDS

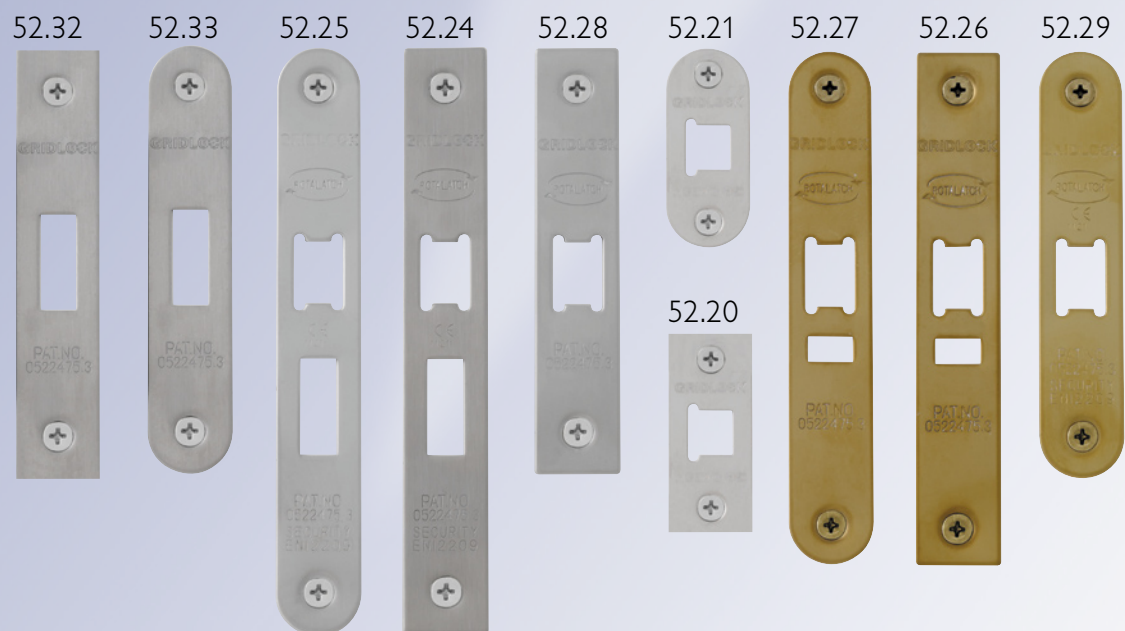



EN12209 – 2003 CLASSIFICATION

1	2	3	4	5	6	7	8	9	10	11
---	---	---	---	---	---	---	---	---	----	----

- 1 Category of use(1-3)**
Grade 1 (low use, high care) to grade 3 (high use, low care)
- 2 Durability**
Graded according to number of operations and the side load applied
- 3 Door mass (1-9)**
Graded according to door mass and maximum closing force
- 4 Fire resistance (0/1)**
Grade 0 – not tested, grade 1 – included in test EN1634-1
- 5 Safety (0/1)**
No requirement
- 6 Corrosion resistance (0-G)**
Graded according to resistance hours and temperature
- 7 Security (0-7)**
Graded according to level of resistance to attack and drilling
- 8 Door application**
Graded according to appropriate applications
- 9 Key operation (0-7)**
Graded according to type of lock and key
- 10 Spindle operation (0-4)**
Graded according to type of latch operation
- 11 Key identification (0-7)**
Graded according to the number of differs and detaining elements.



Intelligent UK Ltd.,
(Trading as Intelligent Hardware)

Jubilee Business Park
Copp Grove, Harrogate HG3 3TB

Tel: 01423 340930

Fax: 01423 340923

E-mail: sales@intelligenthardware.co.uk
www.intelligenthardware.co.uk

THE INTELLIGENT WAY TO BUY